

# Vibhuti Entertainment & Leo Rides



## Company Presentation

**COMPANY NAME:** Vibhuti Entertainment & Leo Rides

### VARIOUS ATTRACTIONS DETAIL

Bowling Alley

Arcade Games

VR Games

Indoor Toddler Area & kids cars, bike, Pony

Soft play & Trampoline park & inflatable item

Adult Bumper cars, Bumber boats, Paddle Boats

E-Karting, Racing, Adult, Kids,

Outdoor rides & Adventure

ATV Bikes, cars, Plane

Swinging Hamster Ball & Fun Tumbling Car

Projection Cricket & Golf



## Vibhuti Entertainment





# Water Slides

NO.	ITEM	PLATFORM HEIGHT(m)	LENGTH(m)
1	Tornado Slide	14.8	
2	Kids Tornado Slide	1.9	
3	Behemoth Slide	10	
4	Space Bowl Slide	10	
5	Aqua Loop Slide	17	100
6	Huge Boomerang Slide	18	132
7	Boomerang Slide	12.5	83
8	kids board Slide	1.9	
9	Competition Slide	15	120*8
10	Rainbow Wavy Slide	12	85*4
11	Cobra Slide	18	130
12	Sled & Barrel Slide	5/7	14/19
13	Crazy Free Fall & Kamikaze Slide	18	80/86
16	Open Spiral & Rafting Slide	10/12	
17	Hill Slide	1.98	12/13
18	Tube Spiral Slide	12	114



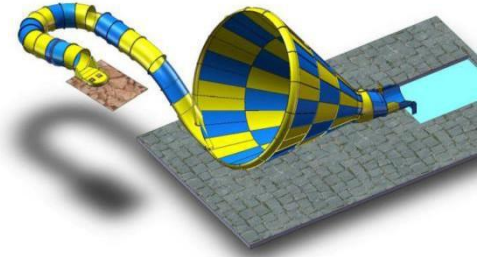

## SPECIFICATION

### Item: Tornado Slide

Platform Height Request: 14.8m Diameter: 18 m

Capacity: 480 persons/hour (4 persons with raft) Power: 90 kW

Floor Space: 58.5\*38meters Water Flow: 960 m3/h

Gel Coats and Resin: DSM / Ashland Brand

Material: Fiberglass Slide & Hot galvanized steel structure

Suitable for visitor who is  $\geq 1.4$  m tall, 40 to 85 kg

Thickness: 8-10 mm

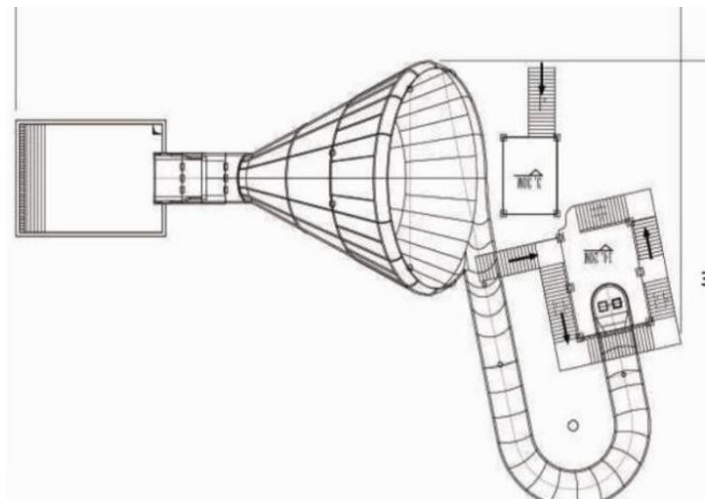

# Vibhuti Entertainment



**VIBHUTI**  
ENTERTAINMENT



## SPECIFICATION

### Item: Kids Tornado Slide

Platform Height: 1.9 m Diameter: 3.6m

Floor space: 13.5\*25 m<sup>2</sup>

Capacity: 360 persons/hour (2 persons with raft) Power:  
22 kW

Gel coats and resin: DSM / Ashland Brand

Material: Fiberglass Slide & Hot galvanized steel structure

Suitable for visitor who is  $\geq 1$  m tall, 30 to 85 kg Thickness:

8 mm

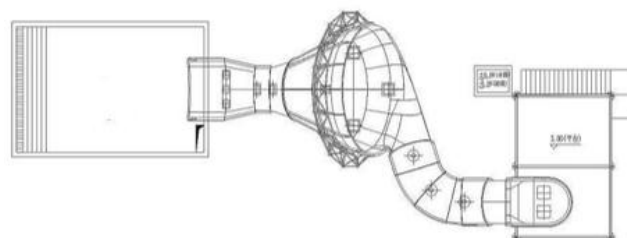

# Vibhuti Entertainment



## SPECIFICATION

### Item: Behemoth Slide

Platform Height Request: 10 m Diameter: 12 m

Floor Space: 13.5\*21m Water Flow: 1,040 m<sup>3</sup>/h

Capacity: 180 persons/hour (1 person body slide) Power: 18.5kW

Water Flow: 200 m<sup>3</sup>/h

Gel Coats and Resin: DSM / Ashland Brand

Material: Fiberglass Slide & Hot galvanized steel structure

Suitable for visitor who is  $\geq 1.1$  m tall, 35 to 90 kg

Thickness: 8 mm

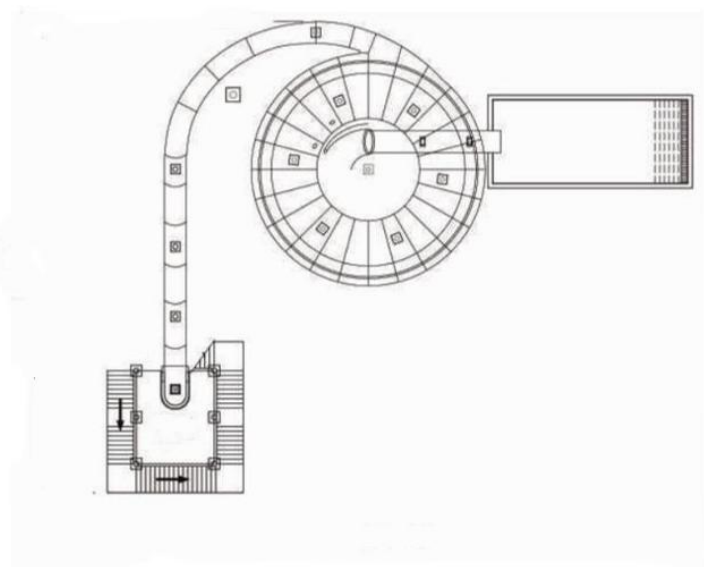

**VIBHUTI**  
ENTERTAINMENT

# Vibhuti Entertainment



## SPECIFICATION

### Item: Aqua Loop Slide

Platform Height Request: 17 m

Length: 100 m

Diameter: 0.8 m

Floor Space: 60\*36m

Capacity: 240 persons/hour (1 person body slide) Power:

26kW

Water Flow: 160 m<sup>3</sup>/h

Gel Coats and Resin: DSM / Ashland Brand

Material: Fiberglass Slide & Hot galvanized steel structure

Suitable for visitor who is 1.4 - 2.0 m tall, 45 to 83 kg

Thickness: 8 mm

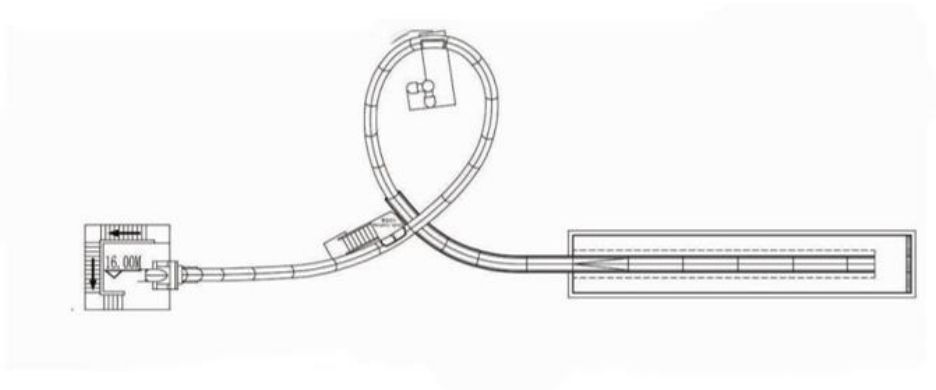



VIBHUTI

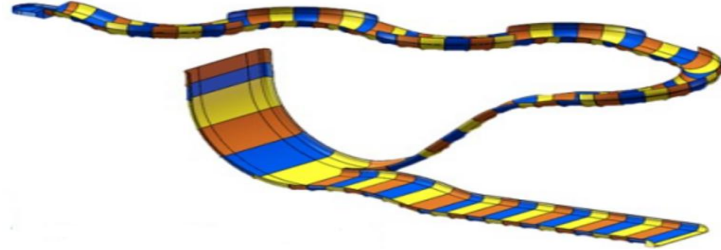

## SPECIFICATION

### Item: Huge Boomerang Slide

Platform Height Request: 18 m Length: 132 m

Width: 3.8-10.8 m

Floor space: 68\*30m

Capacity: 980 persons/hour (4 persons raft)

Power: 96 kW

Water flow: 650 m<sup>3</sup>/h

Gel coats and resin: DSM / Ashland Brand

Material: Fiberglass Slide & Hot galvanized steel structure

Suitable for visitor who is  $\geq 1.4$  m tall, 40 to 85 kg

Thickness: 8-10 mm

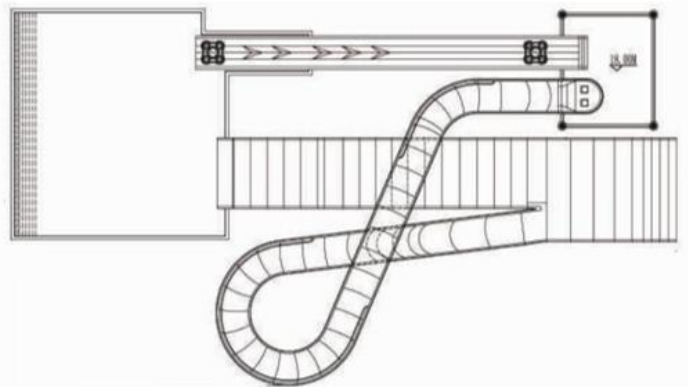

# Vibhuti Entertainment



## SPECIFICATION

### Item: Boomerang Slide

Platform Height Request: 12.5 m

Length: 83 m

Width: 1.5-6 m Floor Space: 57\*21m

Capacity: 360 persons/hour(2 persons raft) Power: 18.5

kW

Water Flow: 320 m3/h

Gel Coats and Resin: DSM / Ashland Brand

Material: Fiberglass Slide & Hot galvanized steel structure

Suitable for visitor who is  $\geq 1.4$  m tall, 35 to 90 kg

Thickness: 8 mm

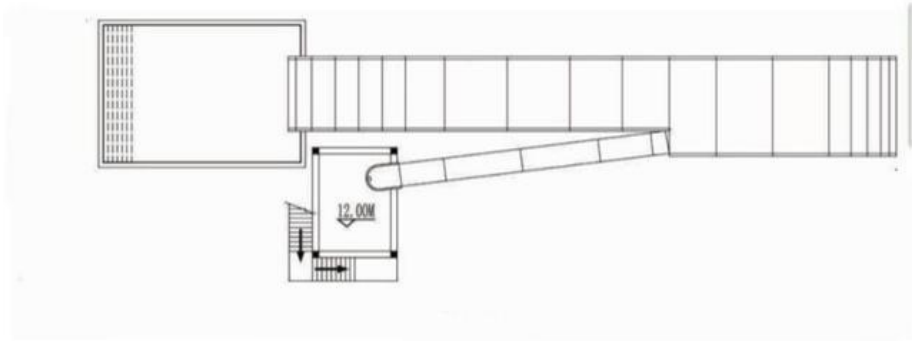

# Vibhuti Entertainment





## SPECIFICATION

### Item: kids board Slide

Platform Height Request: 1.9 m

Length: 83 m

Width: 1.5-6 m Floor Space: 13.9\*4.5m

Capacity: 240 persons/hour(2 persons raft) Power: 11 kW

Water Flow: 200 m<sup>3</sup>/h

Gel Coats and Resin: DSM / Ashland Brand

Material: Fiberglass Slide & Hot galvanized steel structure

Suitable for visitor who is  $\geq 1.4$  m tall, 35 to 90 kg

Minimum Thickness: 6 mm

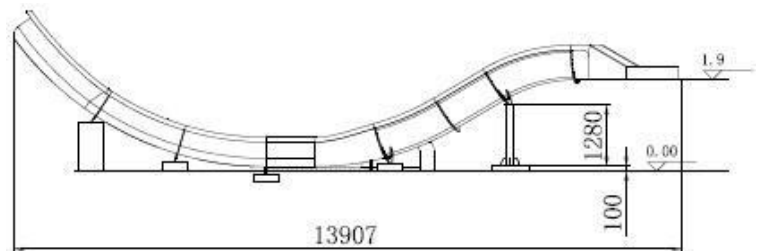
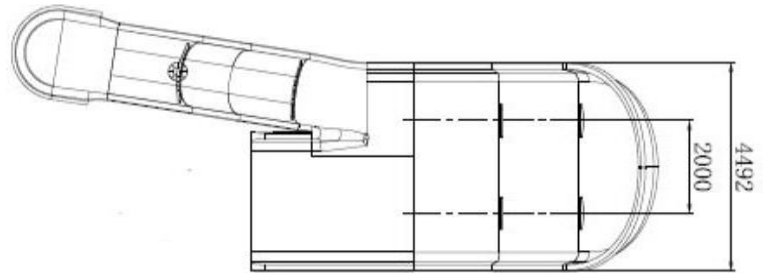

# Vibhuti Entertainment



## SPECIFICATION

### Item: Competition Slide 6 lanes

Platform Height Request: 17 m

Length: 120\*6 m

Width: 0.8meter /lane

Floor space: 100\*22m

Capacity: 980persons/hour (1 person with mat ) Power: 66 kW

Water Flow: 800 m<sup>3</sup>/h

Gel Coats and Resin: DSM / Ashland Brand

Material: Fiberglass Slide & Hot galvanized steel structure

Suitable for visitor who is  $\geq 1.4$  m tall, 35 to 90 kg

Thickness: 8 mm

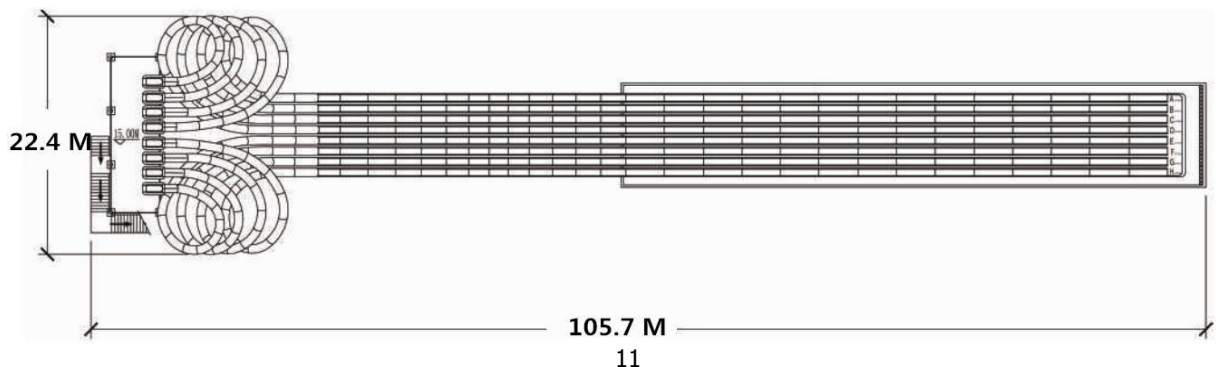
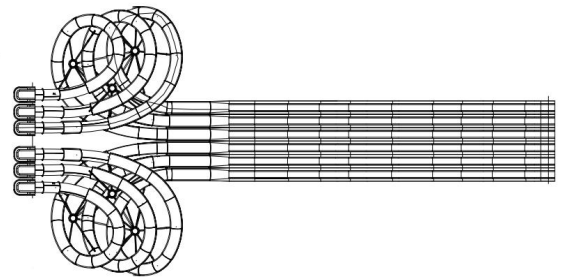

# Vibhuti Entertainment:



**VIBHUTI**  
ENTERTAINMENT



## SPECIFICATION

### Item: Rainbow Wavy Slide 4 lanes

Platform Height: 12 meters (can be customized)

Width: 0.6 m

Capacity: 720 persons/hour( 1 person with mat )

Water Flow: 200 m<sup>3</sup>/h

Gel Coats and Resin: DSM / Ashland Brand

Material: Fiberglass Slide & Hot galvanized steel structure

Suitable for visitor who is 1.4 - 2.0 m tall, 35 to 85 kg

Thickness: 8 mm

Length: 93meters\*4 = 372m

Floor Space: 1,100 m<sup>2</sup>

Power: 22kW

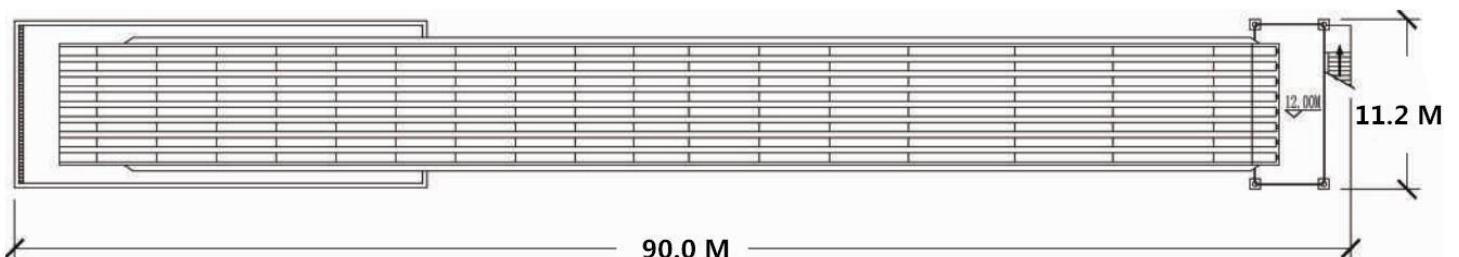

**Vibhuti Entertainment**



## SPECIFICATION

### Item: Cobra Slide

Platform Height Request: 18 m

Length: 130 m

Width: 2.7-13 m Floor space: 60\*22M

Capacity: 480 persons/hour (4 persons with raft) Power:

67 kW

Water Flow: 1,060 m<sup>3</sup>/h

Gel coats and resin: DSM / Ashland Brand

Material: Fiberglass Slide & Hot galvanized steel structure

Suitable for visitor who is  $\geq 1.4$  m tall, 40 to 85 kg

Thickness: 8-10 mm

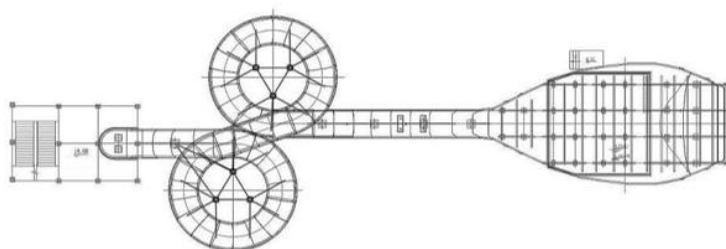



## SPECIFICATION

### Item: Sled & Barrel Slide

Platform Height: 6 m Length: 14/19m Width: 0.8/1.0

Floor space: 15\*6m

Capacity: 360 persons/hour (2 persons body slide) Power:

7.5 kW\*2=15kW

Water flow: 200 m<sup>3</sup>/h

Gel coats and resin: DSM / Ashland Brand

Material: Fiberglass Slide & Hot galvanized steel structure

Suitable for visitor who is  $\geq 1.4$  m tall, 35 to 85 kg

Thickness: 6-8 mm

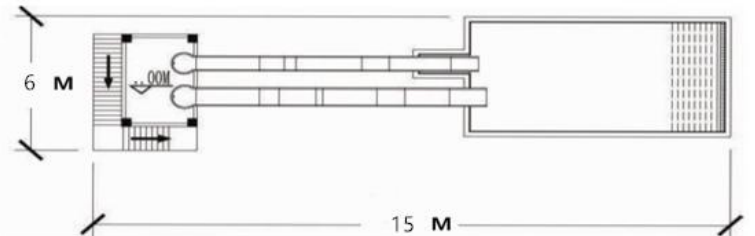



**VIBHUTI**  
ENTERTAINMENT



## SPECIFICATION

### Item: Crazy Free Fall & Kamikaze Slide 2 lane

Platform Height: 15 m(can be customized)

Length: 76m, 84m Width: 0.8 meter/ lane

Floor space: 60\*10 m

Capacity: 240 persons/hour (1 person per lane) Power:

22kW

Water flow: 200 m<sup>3</sup>/h

Gel coats and resin: DSM / Ashland Brand

Material: fiberglass slide & hot galvanized steel structure

Suitable for visitor who is  $\geq 1.4$  m tall, 35 to 90 kg

Thickness: 6-8 mm

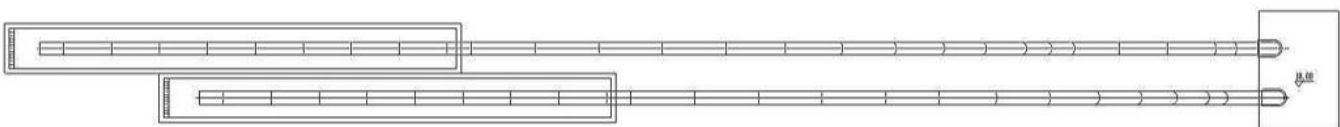



**VIBHUTI**  
ENTERTAINMENT



**VIBHUTI**  
ENTERTAINMENT

**Vibhuti Entertainment**



**VIBHUTI**  
ENTERTAINMENT



## SPECIFICATION

### Item: Open Spiral & Rafting Slide & Tube Slide

Platform Height: 10.2 m (can be customized)

Length: 76m, 110m

Width: 1 meter

Floor space: 2,000 m<sup>2</sup>

Capacity: 180 persons/hour (1 person) + 240 persons/hour (2 persons raft)

Material: Fiberglass Slide & Hot galvanized steel structure

Suitable for visitor who is  $\geq 1.4$  m tall, 40 to 85 kg Thickness: 6 -8 mm



**Vibhuti Entertainment**





## SPECIFICATION

### Item: Tube Spiral Slide

Platform Height: 12 m(can be customized) Length: 114 m

Width: 1.0 m

Floor space: 2,000 m<sup>2</sup>

Capacity: 120 persons/hour (1 person body slide) Power: 15kW

Material: Fiberglass slide & Hot galvanized steel structure

Suitable for visitor who is  $\geq 1.4$  m tall, 35-90 kg Thickness:

8 mm

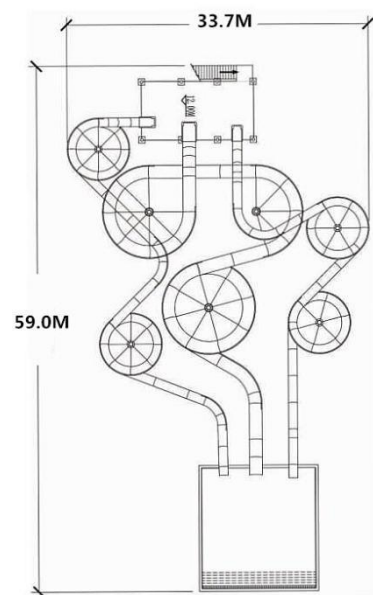

# Vibhuti Entertainment



## SPECIFICATION

### Item: Hill Slide

Platform Height Request: 1.9m Length: 14/16\*2 + 12/13

m Width: 0.8/1.8 m

Floor Space: 300 m<sup>2</sup>

Capacity: 180 persons/hour (1 person /lane)

Material: Fiberglass Slide & Hot galvanized steel structure

Suitable for visitor who is  $\geq 0.7$ m tall,  $\leq 85$  kg Thickness:

6 -8 mm

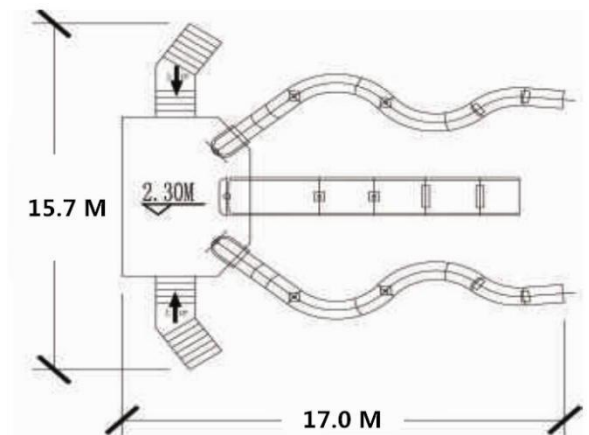

# Interactive Water Playground



## CONTENTS



**Vibhuti Entertainment**

# Large Interactive Water Playground

SW/ 15F

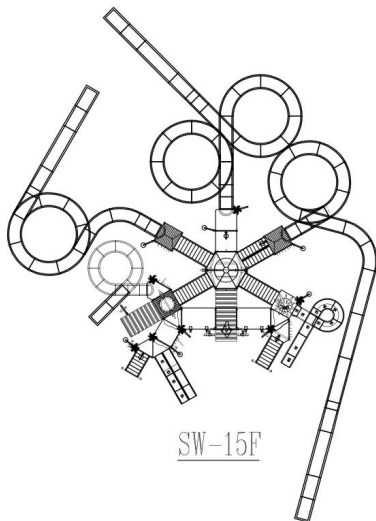

**L:** 41 m

**W:** 32m

**H:** 14 m

- **Slide body material:** Fiberglass
- **Thickness of slide body:** 6-8 mm
- **Structure material:** Steel and Galvanizing treatment



## Vibhuti Entertainment

# Large Interactive Water Playground

SW/21F

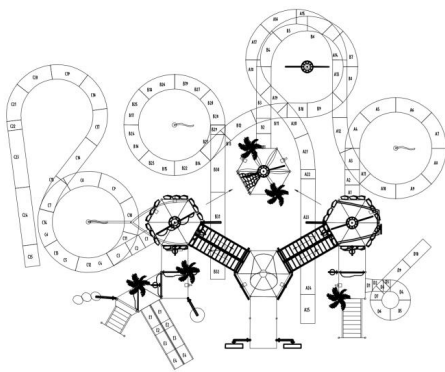

SW-21F

L: 31 m

W: 26m

H: 15 m

- **Slide body material:** Fiberglass
- **Thickness of slide body:** 6-8 mm
- **Structure material:** Steel and Galvanizing treatment



## Vibhuti Entertainment

# Large Interactive Water Playground SW/ H03



**VIBHUTI**  
ENTERTAINMENT



**L: 56 m**

**W: 46 m**

**H: 16 m**

- **Slide body material:** Fiberglass
- **Thickness of slide body:** 6-8 mm
- **Structure material:** Steel and Galvanizing treatment



**Vibhuti Entertainment**

# Medium Interactive Water Playground SW/H02

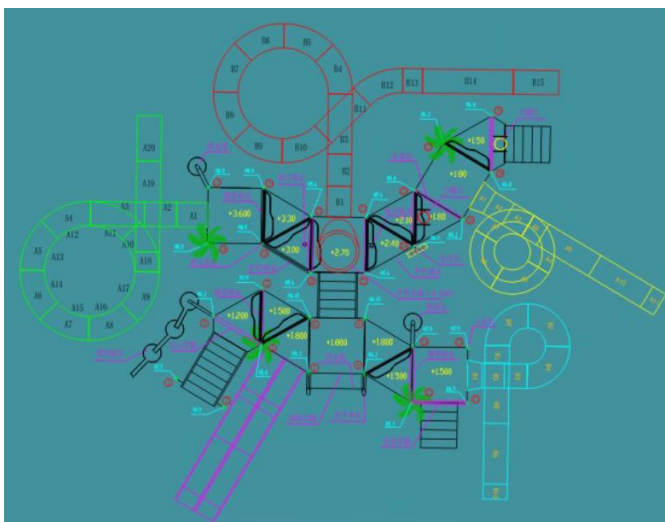

**L:** 23 m

**W:** 22 m

**H:** 14 m

- **Slide body material:** Fiberglass
- **Thickness of slide body:** 6-8 mm
- **Structure material:** Steel and Galvanizing treatment



## Vibhuti Entertainment

# Medium Interactive Water Playground SW/ H03

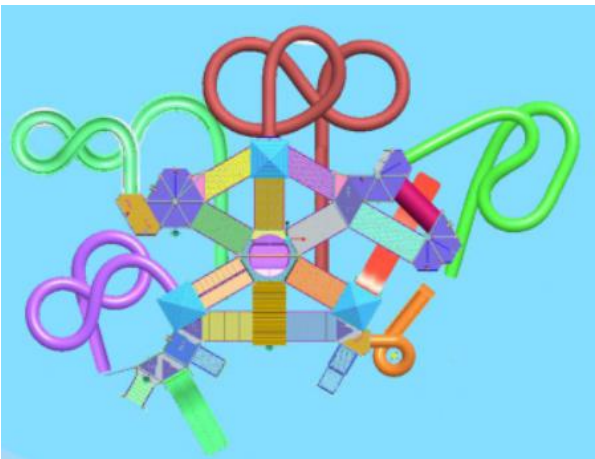

L: 45 m

W: 31m

H: 14 m

- **Slide body material:** Fiberglass
- **Thickness of slide body:** 6-8 mm
- **Structure material:** Steel and Galvanizing treatment



## Vibhuti Entertainment



# Medium Interactive Water Playground

SW/T04



L: 30 m

W: 26m

H: 12 m

- Slide body material: Fiberglass
- Thickness of slide body: 6-8 mm
- Structure material: Steel and Galvanizing treatment

# Medium Interactive Water Playground

SW/B05

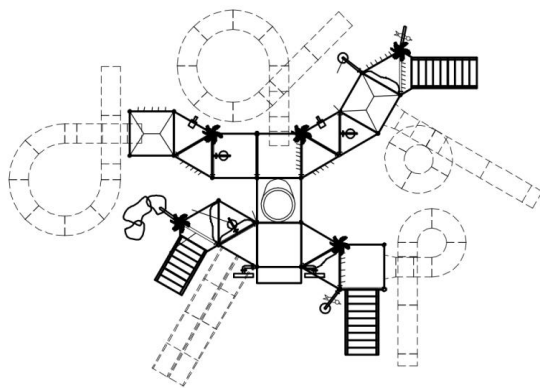

SW-06R-0

L:23 m

W:16m

H: 7 m

- **Slide body material:** Fiberglass
- **Thickness of slide body:** 6-8 mm
- **Structure material:** Steel and Galvanizing treatment



## Vibhuti Entertainment

## Small Interactive Water Playground SW/C01



L:9 m

W:8m

H:6 m

- **Slide body material:** Fiberglass
- **Thickness of slide body:** 6-8 mm
- **Structure material:** Steel and Galvanizing treatment



# Vibhuti Entertainment

# Small Interactive Water Playground SW/C02



L: 11 m

W: 18 m

H: 5.2 m

- Slide body material: Fiberglass
- Thickness of slide body: 6-8 mm
- Structure material: Steel and Galvanizing treatment



## Vibhuti Entertainment

# Small Interactive Water Playground C SW/C03

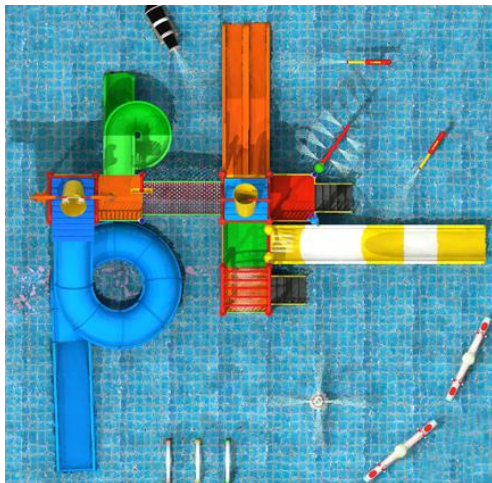

**L:** 14 m

**W:** 14 m

**H:** 5.2 m

- **Slide body material:** Fiberglass
- **Thickness of slide body:** 6-8 mm
- **Structure material:** Steel and Galvanizing treatment



## Vibhuti Entertainment

# Wave pool



**VIBHUTI**  
ENTERTAINMENT



**Wave Making Type: Vacuum** (Tsunami Wave Maker)

Depth of the pool request: 0-1.8 m Min size of the pool: 1,000 m<sup>2</sup>

Length of the wave: 5-15 m

Height of the wave: 2.5-3 m Power: 75 kw per pump

Control Method: PLC ( Programmable Logic Controller )



**VIBHUTI**



## Wave Making Type: Pressure

Depth of the pool request: 0-1.8 m

Min size of the pool: 800 m<sup>2</sup> Length of the wave: 2-10 m

Height of the wave: 0.3-1.2 m Power: 45 kW per pump

Control Method: PLC ( Programmable Logic Controller )

# Lazy River



Depth of the river request: 0.9m

Width of the river request: >2.5m Power: 30 kw

per pump

Active length in straight line : 80-100m per pump

Noise: < 70 decibel

Control Method: Central Control



OUR PROJECTS



